

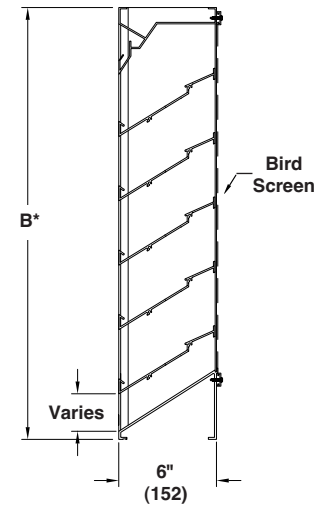

## 6350DS DRAINABLE STATIONARY LOUVER

### EXTRUDED ALUMINUM



#### STANDARD CONSTRUCTION

**FRAME**

6" (152) deep, 6063T6 extruded aluminum with .080" (3.2) nominal wall thickness. Downspouts and caulking surfaces provided.

**BLADES**

6063T6 extruded aluminum with .094" (2.4) nominal wall thickness. Drainable blades are positioned at 35° angle and spaced approximately 4" (102) center to center.

**SCREEN**

5/8" x .040" (16 x 1) expanded, flattened aluminum bird screen in removable frame. Screen adds approximately 1/2" (13) to louver depth.

**FINISH**

Mill.

**MINIMUM SIZE**

12"w x 12"h (305 x 305).

**APPROXIMATE SHIPPING WEIGHT**

6 lbs. per sq. ft. (29.3 kg per m<sup>2</sup>).

**MAXIMUM FACTORY ASSEMBLY SIZE**

Single sections shall not exceed 120"w x 90"h (3048 x 2286) or 90"w x 120"h (2286 x 3048).

Louvers larger than the maximum factory assembly size will require field assembly of smaller sections.

**SUPPORTS**

Louvers may be provided with rear mounted blade supports that increase overall louver depth depending on louver size, assembly configuration or windload.

Consult Reliable for additional information.

#### FEATURES

The 6350DS offers:

- 62% Free Area.
- Beginning point of water penetration at .01 oz./sq. ft. is 1250 fpm @ .18" w.g. and 12,438 cfm.
- Published performance ratings based on testing in accordance with AMCA Publication 511.
- High performance frame system with drainable head collects and removes water to provide excellent water penetration performance.
- Drain gutter in each blade minimizes water cascade between blades.
- Continuous blades up to 120" (3048).
- All aluminum construction for low maintenance and high resistance to corrosion.

#### VARIATIONS

Variations to the basic design of this louver are available at additional cost. They include:

- Extended sill
- Hinged frame
- Front or rear security bars
- Filter racks
- A variety of bird and insect screens
- Selection of finishes: prime coat, 50% PVDF (modified fluoropolymer), epoxy, Pearledize 50 & 70, 70% PVDF, clear and color anodize. (Some variation in anodize color consistency is possible).

Consult Reliable for other special requirements.

#### FRAME CONSTRUCTION

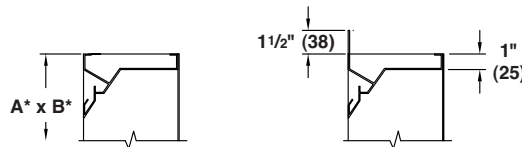

STANDARD

INTEGRAL FLANGE

Dimensions in inches, parenthesis ( ) indicate millimeters.

TAG	QTY.	SIZE		INST. CHANNEL DEPTH	VARIATIONS
		A*-WIDE	B*-HIGH		
PROJECT ARCH./ENGR. REPRESENTATIVE			LOCATION CONTRACTOR DATE		



# PRESSURE DROP

Test size 48" x 48" (1219 x 1219)

**RELIABLE**  
**6350DS**

Ratings do not include the effect of a bird screen.

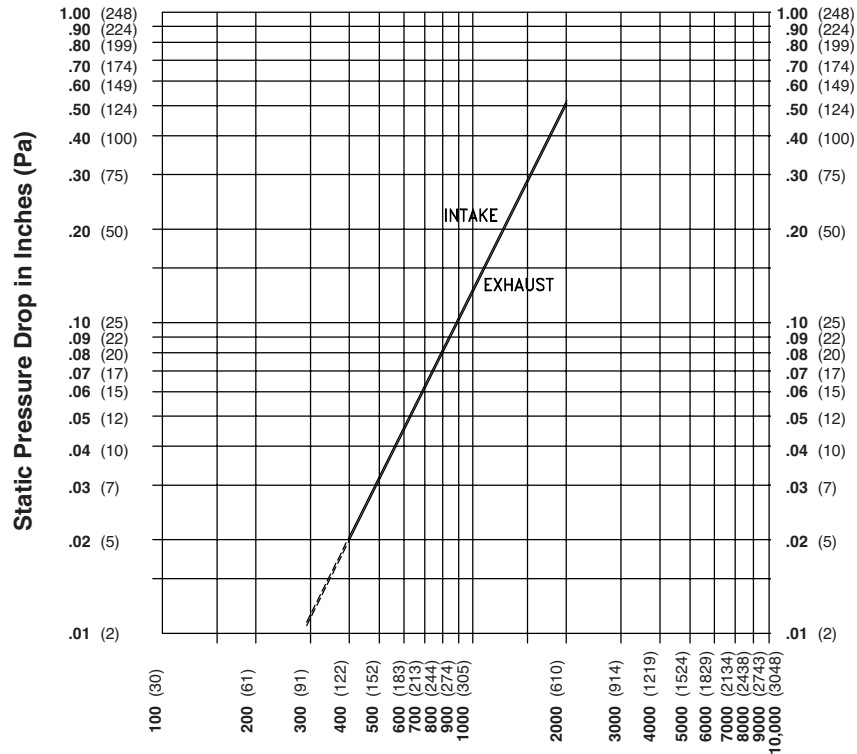

**Air Velocity in feet and (meters) per minute through Free Area**

(Data corrected to standard air density and AMCA figure or figures tested to 5.5)

## WATER PENETRATION

Test size 48" wide x 48" high (1219 x 1219)

Beginning point of water penetration at .01 oz./sq. ft. is 1250 fpm (381 m/min).

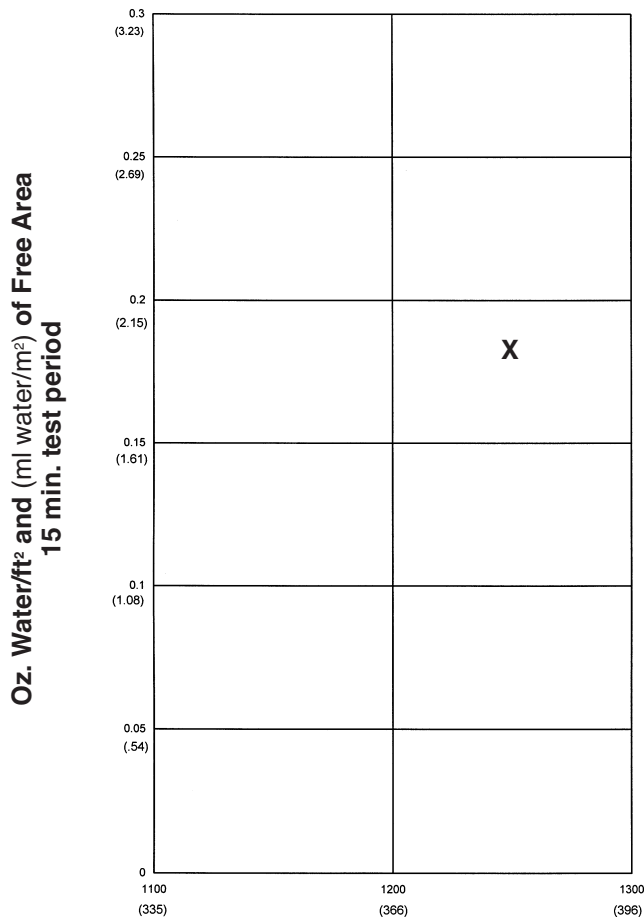

Reliable Products certifies that the 6350DS louvers shown herein are licensed to bear the AMCA Seal. The ratings shown are based on tests and procedures performed in accordance with AMCA Publication 511 and comply with the requirements of the AMCA Certified Ratings Program. The AMCA Certified Ratings Seal applies to air performance ratings and water penetration ratings only.

**Free Area Velocity in feet (meters) per minute. Standard air .075 lb/ft³**

## FRAME CONSTRUCTION

**Standard  
Frame**

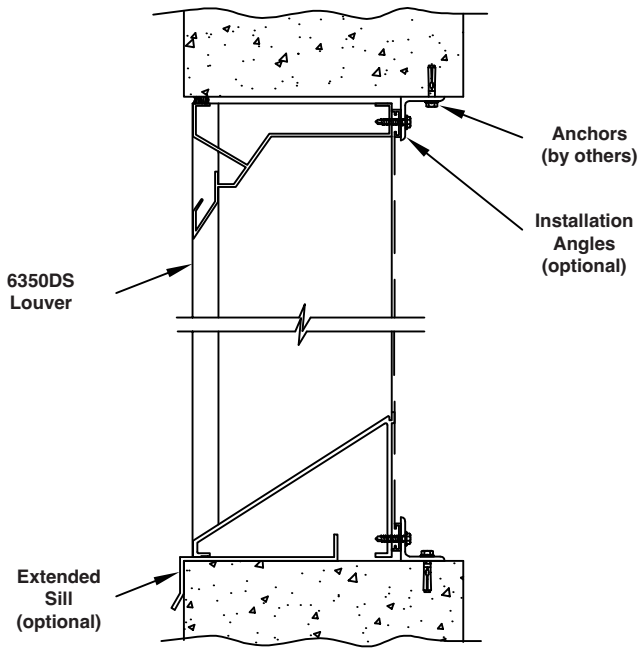

**Flange  
Frame**

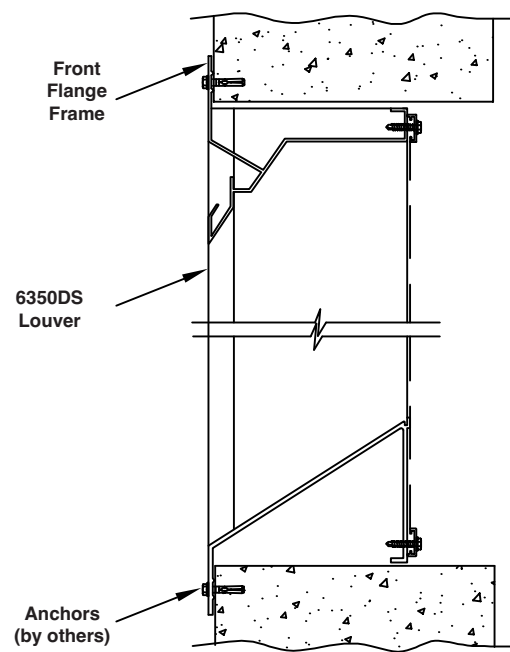

Optional items are available at additional cost. Anchors or other fasteners securing installation angles to substrate are by others.