

TOP VIEW

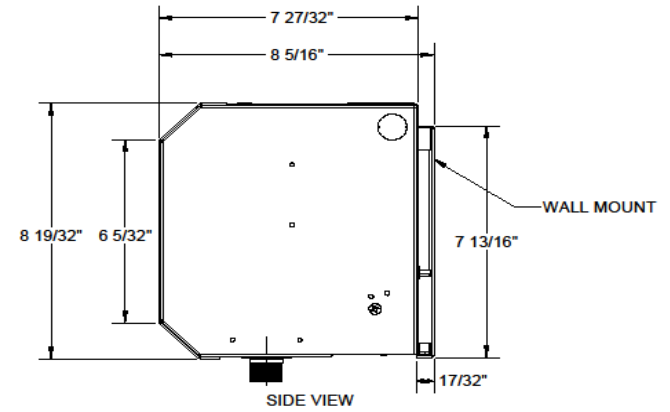

SIDE VIEW

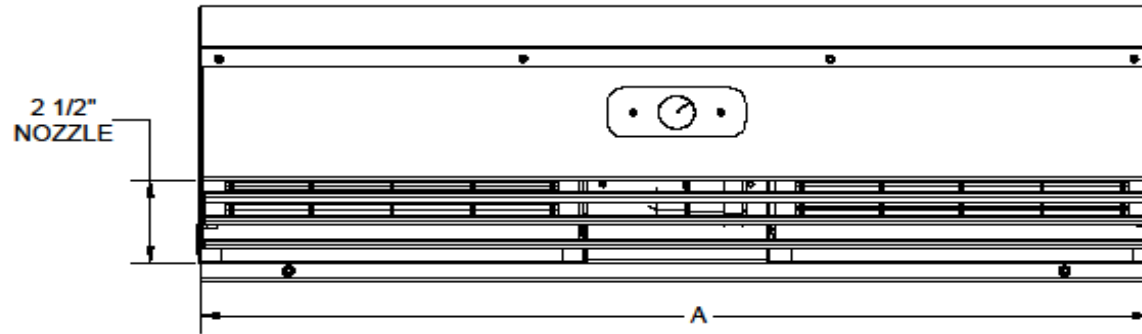

BOTTOM VIEW

RECOMMENDED ACCESSORIES

	<u>Model</u>
▪ Door Switch (standard)	200-1
▪ Door Sw, Hi Traffic;/time delay 115/1	300-1
▪ Door Sw, Hi Traffic /time delay 208-230/1	300-2

STANDARD FEATURES

- High performing, industrial strength
- Corrosion resistant powder-coated exterior cabinet
- Easy threaded-rod installation option
- Five-year parts warranty
- Environmental Protection: 8'
- Manufactured in America since 1916
- Back mounting plate included

Williams Comfort Products reserves the right to alter specifications without prior notice.

MODEL NUMBER	UNIT LENGTH B	NOZZLE LENGTH "A"	THREADED RODS "B"
SLIMT026-00	26	25 7/8	25 1/8
SLIMT036-00	36	35 7/8	35 1/8
SLIMT042-00	42	41 7/8	41 1/8
SLIMT048-00	48	47 7/8	47 1/8
SLIMT060-00	60	59 7/8	59 1/8
SLIMT072-00	72	71 7/8	71 1/8
SLIMT084-00	84 1/8"	83 7/8	83 1/8
SLIMT096-00	96 1/8"	95 7/8	95 1/8
SLIMT108-00	108 1/8"	107 7/8	107 7/8
SLIMT120-00	120 1/8"	119 7/8	119 1/8
SLIMT144-00	144 1/8"	143 7/8	143 1/8

Certifications



Williams Comfort Products certifies that the Air Curtains shown herein are licensed to bear the AMCA Seal. The ratings shown are based on tests and procedures performed in accordance with AMCA Publication 211 and AMCA Publication 311 and comply with the requirements of the AMCA Certified Ratings Program.



Project

Location

Architect

Engineer

PROJECT: _____

DRWG.: _____

ENGINEER/ARCHITECT: _____

CONTRACTOR: _____

PAGE: _____ OF _____

DATE: _____

MODEL	WEIGHT (LBS)	MOTOR DATA							Lab Data		AMCA Data				
		MOTOR HP	MOTOR RPM	Qty Motors	FLA* SINGLE PHASE		FLA* THREE PHASE		MAX FPM At Nozzle	MAX CFM	LwA dBA	Average Velocity FPM	Average CFM	Uniformity %	Power Rating (kW)
					115V	208V/230 V	208V/230 V	460V							
SLIMT026-00	35	1/4	1,600	1	3.2	1.5	N/A	N/A	4,600	2,000	79	5429	714	59	0.22
SLIMT036-00	40	1/4	1,600	1	3.2	1.5	N/A	N/A	2,400	1,500	77	2944	965	54	0.168
SLIMT042-00	45	1/4	1,600	1	3.2	1.5	N/A	N/A	2,500	1,850	77	3436	882	56	0.198
SLIMT048-00	50	1/4	1,600	1	3.2	1.5	N/A	N/A	2,250	1,875	77	3533	1057	60	0.218
SLIMT060-00	59	1/4	1,600	1	3.2	1.5	N/A	N/A	2,300	2,400	78	3313	1313	66	0.237
SLIMT072-00	68	1/4	1,600	1	3.2	1.5	N/A	N/A	2,350	2,900	78	3675	1827	70	0.301
SLIMT084-00	90	1/4	1,600	2	6.4	3.0	N/A	N/A	2,500	3,700	77	3436	1764	56	0.396
SLIMT096-00	100	1/4	1,600	2	6.4	3.0	N/A	N/A	2,250	3,750	77	3533	2114	60	0.436
SLIMT108-00	109	1/4	1,600	2	6.4	3.0	N/A	N/A	2,300	4,300	78	3313	2376	60	0.455
SLIMT120-00	118	1/4	1,600	2	6.4	3.0	N/A	N/A	2,300	4,850	78	3313	2638	66	0.474
SLIMT144-00	136	1/4	1,600	2	6.4	3.0	N/A	N/A	2,350	5,900	78	3675	3654	70	0.602

-The AMCA Certified Ratings Seal applies to airflow rate, average outlet velocity, outlet velocity uniformity, velocity projection and power rating at free delivery only.
 -Rated data shown are only for base (unheated) units, as shown. -The A-weighted sound ratings shown have been calculated per AMCA International Standard 301.
 -Installation Type A: free inlet, free outlet

- Operation at 50 Hz will generate approximately a 17% reduction in performance
- Rated data shown for unheated units
- All units greater than 6' are comprised of 2 units and with the trim kit they are 1/8" wider (144"= 72" + 72"+1/8") and require two power sources or equivalent ampacity.
- **EQUIPMENT SPECIFICATIONS** – Standard features, other options available
- **GENERAL DESCRIPTION**– Air curtains are to be Slim Tech models, made by Williams Comfort Products
- **CABINET** – Constructed of heavy-gauge galvanized steel, treated with a powder-coated epoxy finish for corrosion resistance. Designed for easy access to filter and for service maintenance. Equipped with easily adjustable aluminum vanes for the most efficient air flow as needed. Easy direct-wall mount (key slots) or top threaded-rod installation option. Available in stainless, white, black and custom colors.
- **MOTORS & FAN WHEELS** – Motors are ¼ HP, controlled by a variable speed control; galvanized wheels and a housing fabricated of galvanized durable steel.
- **ELECTRICAL**– All motor leads are terminated in an internal, watertight junction box (1) per motor.
- **APPROVALS** – Air curtains meet the requirements of the National Electric Code and are ETL certified to UL Standard 1995. Also in accordance with AMCA Publication 211 and 311 and comply with the requirements of the AMCA Certified Ratings Program.
- **ACCESSORIES** – Please see options and accessories page

*For minimum circuit ampacity, multiply FLA x 1.25

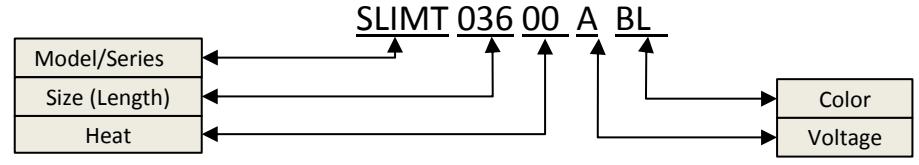

Size	Code
26"	026
36"	036
42"	042
48"	048
60"	060
72"	072
84"	084
96"	096
108"	108
120"	120
144"	144

MODEL	Projection Velocity	
	Distance from nozzle (in)	Average core velocity (FPM)
SLIMT072-00	40	1656
	60	1333
	80	1139

Color	Code	Voltage	Code	Heat Options
White	WH	115/1	A	
Black	BL	208/1	C	See Heated Submittal
Stainless	SS	230/1	D	



250 West Laurel Street ▪ Colton ▪ CA ▪ 92324
 909.825.0093 ▪ www.wfc-fc.com

SLIM TECH Series - (Unheated)