

ELC6375DXW DRAINABLE COMBINATION WAREHOUSE LOUVER EXTRUDED ALUMINUM

APPLICATION

The Architecturally pleasing Ruskin ELC6375DXW warehouse louver has a 6" deep frame with 37° angle stationary drainable front blades and adjustable rear blades. The ELC6375DXW is specifically designed to provide high rates of ventilation for warehouse applications. Factory mounted and commissioned electric or pneumatic actuators are available upon request.

STANDARD CONSTRUCTION

FRAME

6" (152) deep, 6063T6 extruded aluminum with .125" (3.2) nominal wall thickness. Downspouts and caulking surfaces provided.

BLADES

Front stationary drainable blades – 6063T6 extruded aluminum with .081" (2.1) nominal wall thickness, positioned at 37½° angle and spaced approximately 6⅛" (156) on center. Rear adjustable airfoil blades – 6063T6 extruded aluminum, .140" (3.6) nominal wall thickness.

SCREEN

⅝" x .040 (16 x 1) expanded, flattened aluminum bird screen in removable frame. Screen adds approximately ½" (13) to louver depth.

SEALS

Extruded vinyl blade edge seals on rear adjustable blades and flexible, compressible aluminum jamb seals.

LINKAGE

Concealed in frame.

BEARINGS

Stainless steel sleeve pressed into frame.

AXLES

½" (13) plated steel hex.

ACTUATOR

Locking louver quadrant.

FINISH

Mill.

MINIMUM SIZE

12" w x 12" h (305 x 305).

APPROXIMATE SHIPPING WEIGHT

8 lbs. per sq. ft. (39.1 kg per m²).

MAXIMUM FACTORY ASSEMBLY SIZE

Shall be 120" w x 96" h (3048 x 2438) with standard frame, 120" w x 93" h (3048 x 2362) with integral flange frame. Maximum operating section width is 60" (1524). Louvers larger than the maximum factory assembly size will require field assembly of smaller sections.

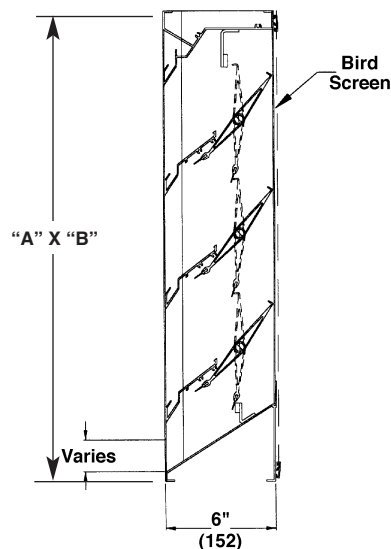

FEATURES

The ELC6375DXW offers:

- 47% Free Area.
- Published performance ratings based on testing in accordance with AMCA Publication 511.
- Concealed blade linkage is protected from weather exposure and reduces required installation depth.
- Adjustable rear blades provide desired shut off in the same 6" (152) deep frame normally required by a louver alone.
- Blade and jamb seals provide tight closure.
- High performance frame system with drainable head collects and removes water to provide excellent water penetration performance.
- A drain gutter in each front stationary blade minimizes water cascade between blades.
- Architecturally styled hidden mullions allowing continuous line appearance up to 120" (3048).

VARIATIONS

Variations to the basic design of the louver are available at additional cost. They include:

- Extended sill.
- Hinged frame.
- Front or rear security bars.
- Filter racks.
- Installation angles.
- A variety of bird and insect screens.
- A selection of manual, electric, and pneumatic actuators.
- Selection of finishes: prime coat, baked enamel (modified fluoropolymer), epoxy, Acrodize, Kynar, clear and color anodize. (Some variation in anodize color consistency is possible).

Consult Ruskin for other special requirements.

FRAME CONSTRUCTION

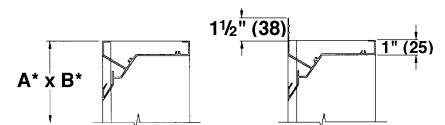

STANDARD

INTEGRAL FLANGE

Dimensions in inches, parenthesis () indicate millimeters.

TAG	QTY.	SIZE		FRAME	VARIATIONS
		A*-WIDE	B*-HIGH		
PROJECT			LOCATION		
ARCH./ENGR.			CONTRACTOR		
REPRESENTATIVE			DATE		

SUGGESTED SPECIFICATIONS

Furnish and install at locations shown on plans or as described in schedules. Combination louvers to incorporate both stationary drainable front blades and rear adjustable airfoil blades in a single 6" (152) deep frame. Combination louvers shall be manufactured in an ISO-9001 certified factory.

Louver sizes too large for shipping shall be built up by the contractor from factory assembled louver sections to provide overall sizes required. Louver design shall incorporate structural supports required to withstand a wind load of 20 lbs. per sq. ft. (.96kPa). Combination louvers shall be furnished with bird and or insect screens, quadrant arm, electric, pneumatic or manual actuators, supports and finishes as specified and as required for a complete installation.

Louvers shall be Ruskin Model ELC6375DXW extruded 6063T6 aluminum alloy

construction as follows:

MATERIAL

Frame: .125 (3.2) wall thickness, caulking surfaces provided.
Blades: Front Blades Stationary .081 (2.1) thick drainable blades positioned at 37½ angle, spaced at 6 1/8" (156) on center. (Blades overlapping frames is unacceptable).

Bearings: Stainless steel sleeve bearings pressed into frame.
Axle: ½" (13) diameter hexagonal positively locked into the louver blade.
Linkage: Concealed out of airstream, within the louver frame to reduce pressure drop and noise.
Jamb Seals: Stainless steel compression type to prevent leakage between blade end and damper frame
Screen: 5/8" x .040 (16 x 1) expanded flattened aluminum bird screen in removable frame.
Finish: Select finish specification from Ruskin Finishes Brochure.

Published louver performance data bearing the AMCA Certified Ratings Seal for Air Performance must be submitted for approval prior to fabrication and must demonstrate pressure drop and water penetration equal to or less than the Ruskin model specified. Combination Warehouse louver shall be in all respects equivalent to the Ruskin model ELC6375DXW.

PERFORMANCE DATA

AMCA Standard 500 provides a reasonable basis for testing and rating louvers. Testing to AMCA 500 is performed under a certain set of laboratory conditions. This does not guarantee that other conditions will not occur in the actual environment where louvers must operate.

The louver system should be designed with a reasonable safety factor for louver performance. To ensure protection from water carry-over, design with a performance level somewhat below maximum desired pressure drop and .01 oz./sq. ft. of water penetration.

WATER PENETRATION

Test size 48" wide x 48" high (1219 x 1219)

Beginning point of water penetration at .01 oz./sq. ft. is 1169 fpm (356 m/min).

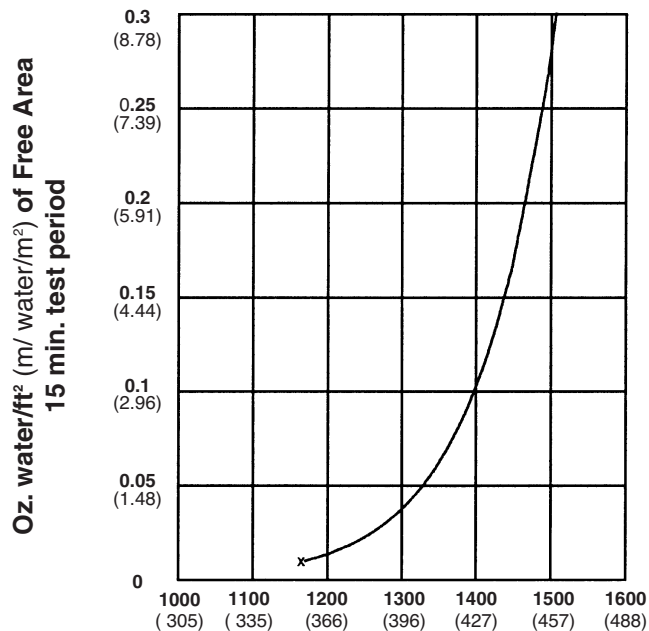

Ruskin Company certifies that the ELC6375DXW louvers shown herein are licensed to bear the AMCA Seal. The ratings shown are based on tests and procedures performed in accordance with AMCA Publication 511 and comply with the requirements of the AMCA Certified Ratings Program. The AMCA Certified Ratings Seal applies to air performance rating and water penetration ratings only.

Free Area Velocity in feet (meters) per minute
Standard air .075 lb/ft³

PRESSURE DROP

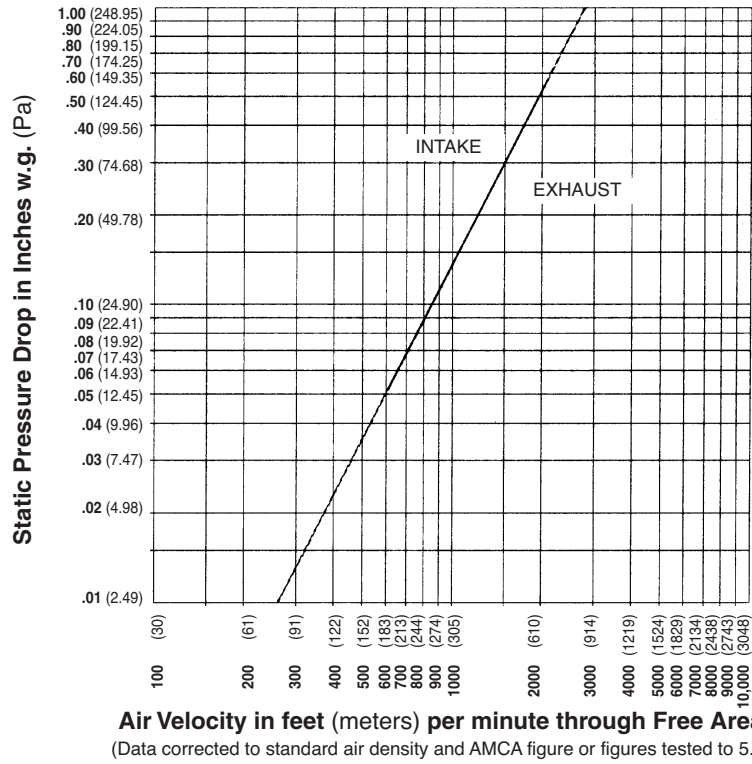

Ratings do not include the effect of a bird screen.

FREE AREA GUIDE

Free Area Guide shows free area in ft² and m² for various sizes of ELC6375DXW.

Width – Inches (Meters)

Height – Inches (Meters)

	12	18	24	30	36	42	48	54	60	66	72	78	84	90	96	102	108	114	120
	0.30	0.46	0.61	0.76	0.91	1.07	1.22	1.37	1.52	1.68	1.83	1.98	2.13	2.29	2.44	2.59	2.74	2.90	3.05
12	0.22	0.35	0.48	0.61	0.74	0.87	1.01	1.14	1.27	1.36	1.49	1.62	1.75	1.88	2.01	2.14	2.27	2.41	2.54
0.30	0.02	0.03	0.04	0.06	0.07	0.08	0.09	0.11	0.12	0.13	0.14	0.15	0.16	0.17	0.19	0.20	0.21	0.22	0.24
18	0.45	0.73	1.00	1.27	1.54	1.81	2.08	2.36	2.63	2.81	3.08	3.35	3.63	3.90	4.17	4.44	4.71	4.98	5.26
0.46	0.04	0.07	0.09	0.12	0.14	0.17	0.19	0.22	0.24	0.26	0.29	0.31	0.34	0.36	0.39	0.41	0.44	0.46	0.49
24	0.69	1.10	1.51	1.93	2.34	2.75	3.16	3.58	3.99	4.26	4.68	5.09	5.50	5.91	6.33	6.74	7.15	7.56	7.98
0.61	0.06	0.10	0.14	0.18	0.22	0.26	0.29	0.33	0.37	0.40	0.43	0.47	0.51	0.55	0.59	0.63	0.66	0.70	0.74
30	0.92	1.48	2.03	2.58	3.13	3.69	4.24	4.79	5.35	5.72	6.27	6.82	7.38	7.93	8.48	9.03	9.59	10.14	10.69
0.76	0.09	0.14	0.19	0.24	0.29	0.34	0.39	0.45	0.50	0.53	0.58	0.63	0.69	0.74	0.79	0.84	0.89	0.94	0.99
36	1.16	1.85	2.54	3.24	3.93	4.63	5.32	6.01	6.71	7.17	7.86	8.56	9.25	9.94	10.64	11.33	12.03	12.72	13.41
0.91	0.11	0.17	0.24	0.30	0.37	0.43	0.49	0.56	0.62	0.67	0.73	0.80	0.86	0.92	0.99	1.05	1.12	1.18	1.25
42	1.39	2.23	3.06	3.89	4.73	5.56	6.40	7.23	8.07	8.62	9.46	10.29	11.13	11.96	12.79	13.63	14.46	15.30	16.13
1.07	0.13	0.21	0.28	0.36	0.44	0.52	0.59	0.67	0.75	0.80	0.88	0.96	1.03	1.11	1.19	1.27	1.35	1.42	1.50
48	1.63	2.60	3.58	4.55	5.53	6.50	7.48	8.45	9.43	10.08	11.05	12.03	13.00	13.98	14.95	15.93	16.90	17.88	18.85
1.22	0.15	0.24	0.33	0.42	0.51	0.60	0.70	0.79	0.88	0.94	1.03	1.12	1.21	1.30	1.39	1.48	1.57	1.66	1.75
54	1.86	2.98	4.09	5.21	6.32	7.44	8.55	9.67	10.78	11.53	12.64	13.76	14.88	15.99	17.11	18.22	19.34	20.45	21.57
1.37	0.17	0.28	0.38	0.48	0.59	0.69	0.80	0.90	1.00	1.07	1.18	1.28	1.38	1.49	1.59	1.69	1.80	1.90	2.01
60	2.22	3.56	4.89	6.22	7.55	8.89	10.22	11.55	12.89	13.78	15.11	16.44	17.78	19.11	20.44	21.78	23.11	24.44	25.78
1.52	0.21	0.33	0.45	0.58	0.70	0.83	0.95	1.07	1.20	1.28	1.41	1.53	1.65	1.78	1.90	2.03	2.15	2.27	2.40
66	2.21	3.53	4.85	6.18	7.50	8.83	10.15	11.47	12.80	13.68	15.00	16.33	17.65	18.97	20.30	21.62	22.95	24.27	25.59
1.68	0.21	0.33	0.45	0.57	0.70	0.82	0.94	1.07	1.19	1.27	1.40	1.52	1.64	1.76	1.89	2.01	2.13	2.26	2.38
72	2.31	3.70	5.09	6.48	7.86	9.25	10.64	12.03	13.41	14.34	15.73	17.11	18.50	19.89	21.28	22.66	24.05	25.44	26.83
1.83	0.22	0.34	0.47	0.60	0.73	0.86	0.99	1.12	1.25	1.33	1.46	1.59	1.72	1.85	1.98	2.11	2.24	2.37	2.49
78	2.68	4.28	5.89	7.49	9.10	10.70	12.31	13.91	15.52	16.59	18.19	19.80	21.40	23.01	24.61	26.22	27.82	29.43	31.03
1.98	0.25	0.40	0.55	0.70	0.85	1.00	1.14	1.29	1.44	1.54	1.69	1.84	1.99	2.14	2.29	2.44	2.59	2.74	2.89
84	2.78	4.45	6.12	7.79	9.46	11.13	12.79	14.46	16.13	17.24	18.91	20.58	22.25	23.92	25.59	27.26	28.93	30.60	32.26
2.13	0.26	0.41	0.57	0.72	0.88	1.03	1.19	1.35	1.50	1.60	1.76	1.91	2.07	2.22	2.38	2.53	2.69	2.85	3.00
90	3.14	5.03	6.92	8.80	10.69	12.58	14.46	16.35	18.23	19.49	21.38	23.27	25.15	27.04	28.92	30.81	32.70	34.58	36.47
2.29	0.29	0.47	0.64	0.82	0.99	1.17	1.34	1.52	1.70	1.81	1.99	2.16	2.34	2.51	2.69	2.87	3.04	3.22	3.39
96	3.25	5.20	7.15	9.10	11.05	13.00	14.95	16.90	18.85	20.15	22.10	24.05	26.00	27.95	29.90	31.85	33.80	35.75	37.70
2.44	0.30	0.48	0.66	0.85	1.03	1.21	1.39	1.57	1.75	1.87	2.06	2.24	2.42	2.60	2.78	2.96	3.14	3.32	3.51

AIR LEAKAGE

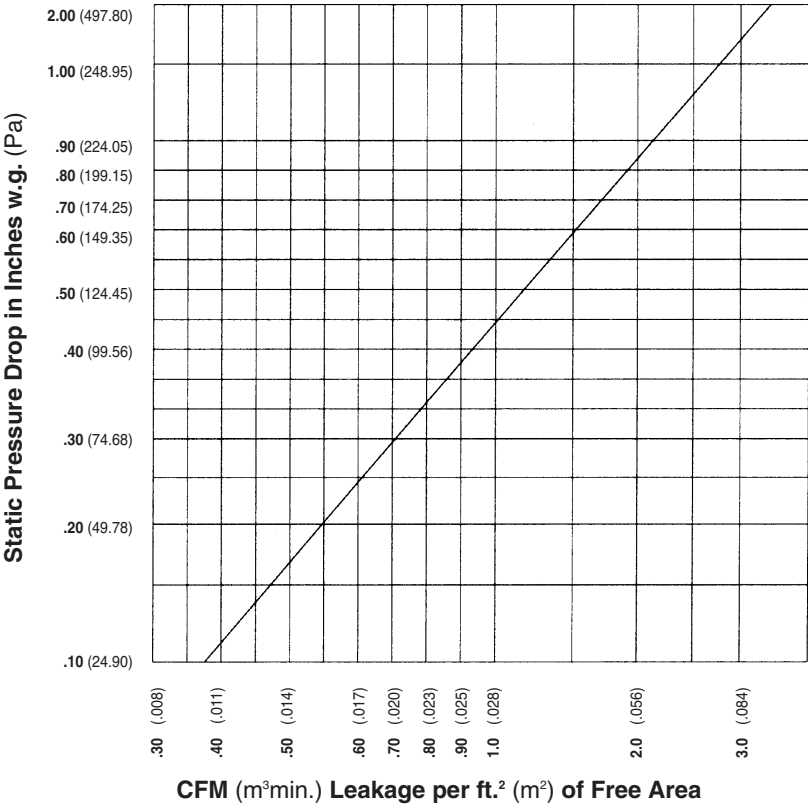

TYPICAL INSTALLATION DETAILS

Masonry Wall

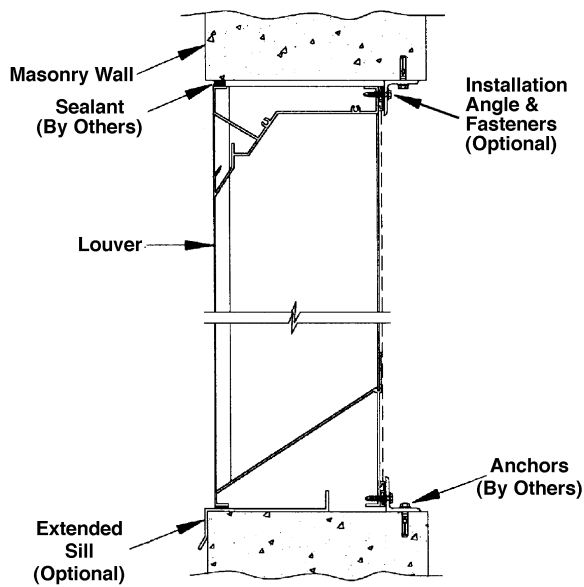

Metal Panel Wall

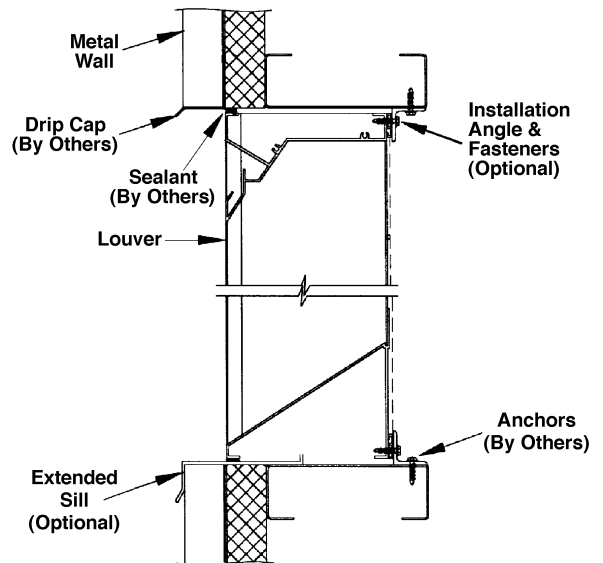

Flange Mount

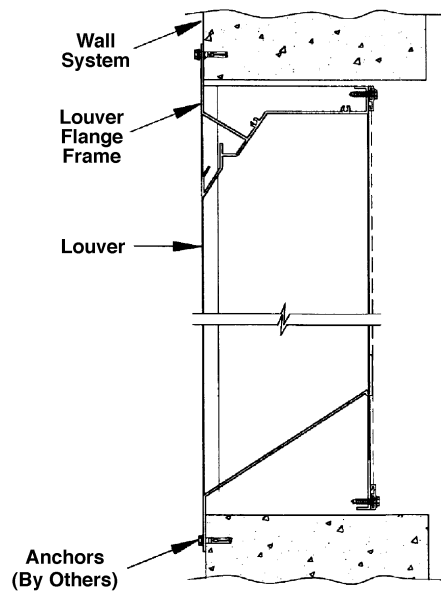

Wood Installation

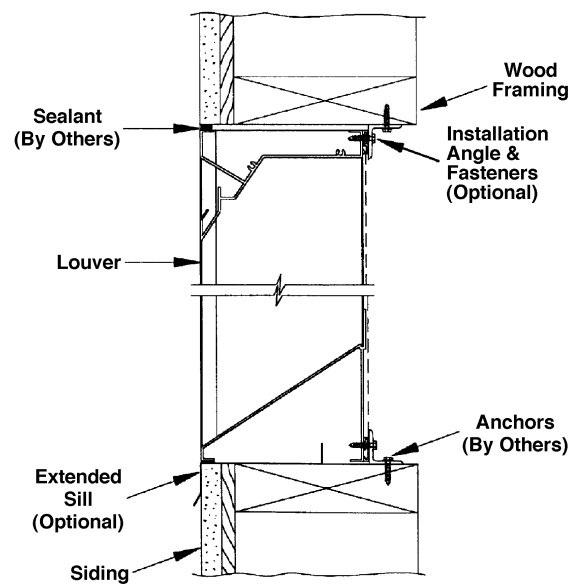

Optional items are available at additional cost.

RUSKIN®

3900 Dr. Greaves Rd.
Kansas City, MO 64030
(816) 761-7476
FAX (816) 765-8955
www.ruskin.com