

Fan NCF 30/20, 60 Hz, 3ph

Centrifugal fan for industrial process ventilation



Nederman NCF 30/20 is a centrifugal fan designed for use in all types of industrial process and ventilation systems, mounted indoor as well as outdoor. The fan is equipped with vibration absorbers as standard.

Accessories

- In and outlet adapters
- Guard nets for in and outlet adapters
- Fan Starters
- Fan Inverters

See separate information

Part no 14521928, 208V
Part no 14522828, 230/460V
Part no 14523728, 575V

Technical specification

Capacity:	410 - 2540 cfm
Total pressure:	11.6 - 3.8 in w.g.
Motor power:	4.0 hp
Speed:	3515 rpm
Voltage:	208V/3ph, 230/460V/3ph, 575V/3ph
Frequency:	60 Hz
Current at rated voltage:	11.5A at 208V, 10.4A at 230V, 5.2A at 460V, 4.2A at 575V
Degree of protection:	IP 55
Weight:	187 lbs
Impeller:	Backward curved blades
General material:	Sheet metal steel
Construction:	On the outside the fan scroll is joined to the standing fan sides by folded seams. The inside is intermittently welded.
Color:	Grey, RAL 7045
Surface treatment:	Anodic electro coating
Pre coat:	Epoxy, 0.8 mil
Top coat:	2 component acrylic, 1.2 mil
Max dust concentration:	0.0874 grain/ft ³
Max particle size:	400 mil
Applied directives:	2006/42/CE Machine Directive 2006/95/EC Low Voltage Directive (LVD) 2004/108/EC Electromagnetic compatibility (EMC)

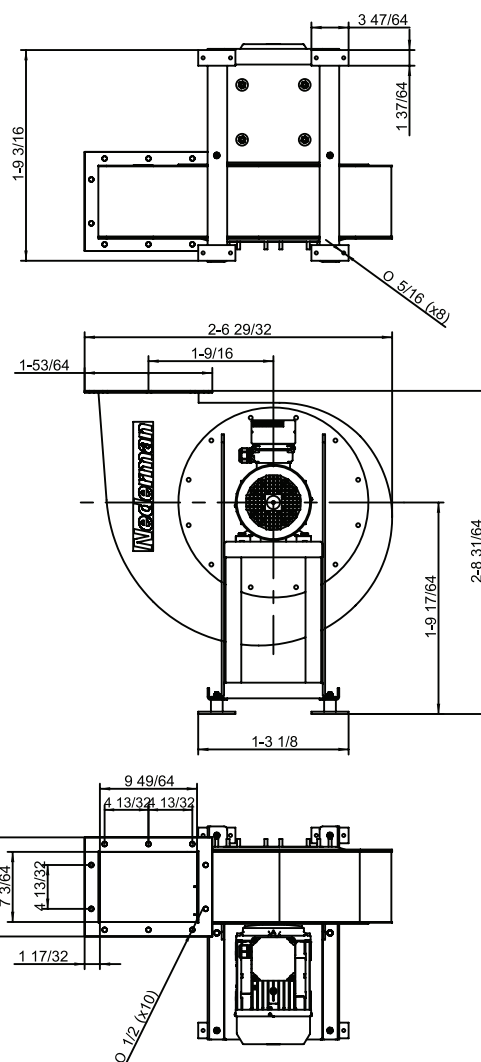

Duct inlet diameter 9 16/19 in
Duct outlet diameter 9 16/19 in



AB PH NEDERMAN & CO certifies that the Fan NCF 30/20 shown herein is licensed to bear the AMCA Seal. The ratings shown are based on tests and procedures performed in accordance with AMCA Publication 211, AMCA Publication 311 and comply with the requirements of the AMCA Certified Ratings Program.

WARNING!

Risk of fire or explosion! The fan must not be used in an environment with danger of explosion or for transport of inflammable or explosive gases.

Outlet directions

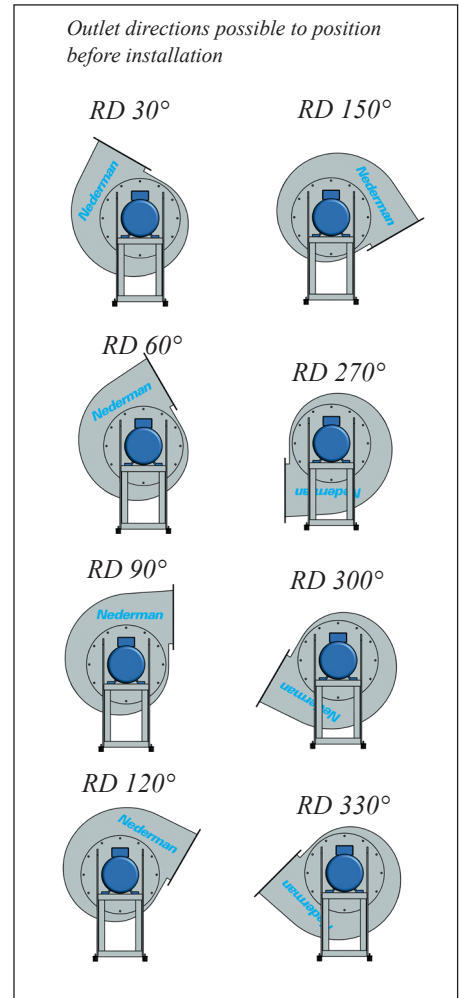
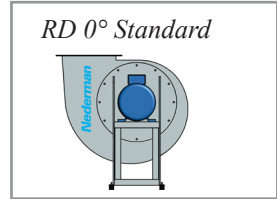

Fan diagram

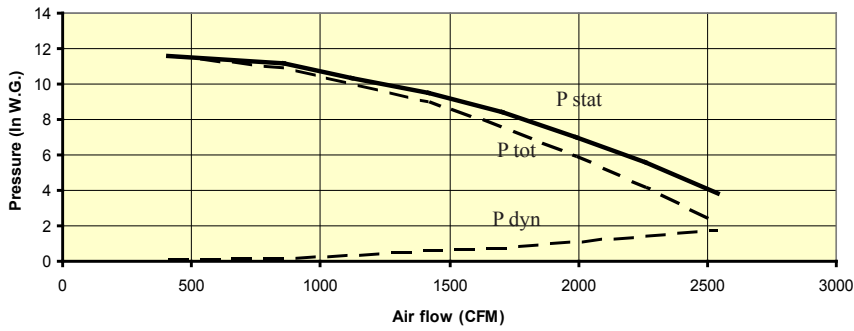

Shaft Power

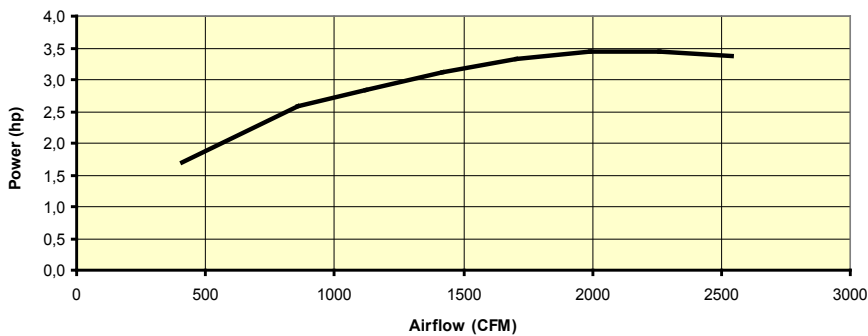

Efficiency

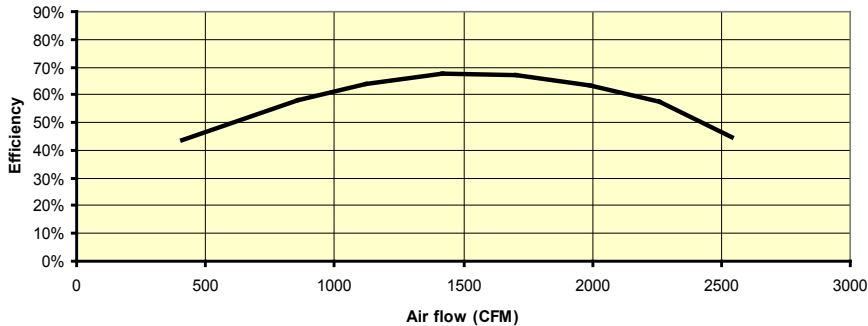

Impeller speed: 3515 rpm

Test method per ANSI/AMCA Standard 210-99, figure 12 set up.

Power rating (BHP) does not include transmission losses.

Performance ratings do not include the effects of appurtenances (accessories).

Values shown are for inlet Lwi sound power levels for Installation Type B: free inlet, ducted outlet.

The sound power level ratings shown are in decibels, referred to 10⁻¹² watts, calculated per AMCA International Standard 301.

Lwmi (Sound power level measured at the open inlet of the fan)											
unit of measure dB											
Center frequency (Hz)								Operation point			
63	125	250	500	1000	2000	4000	8000	pressure (in.wg)	flow (cfm)	rotation speed (r.p.m)	number
87	84	85	88	86	86	85	79	0,00	2823	3533	1
86	81	82	85	83	84	81	75	5,30	2109	3525	2
85	81	81	84	81	82	79	73	9,10	1407	3532	3
86	83	84	85	83	83	79	74	11,30	706	3541	4