

FEATURES & ADVANTAGES OF MASTERCOOL AXIAL FANS

- ★ Heavy-duty cast iron pillow block ball bearings for fan blade
- ★ GFCI protected pump circuit
- ★ AMCA Performance Licensed
- ★ Plastic reservoir and media shields protect cabinet from water
- ★ Belt tension with screw adjustment
- ★ Bolted cabinet for easy parts replacement
- ★ Fine grid intake grille prevents evaporative media plugging
- ★ More air delivery per horsepower than centrifugal blower type units

Components Included:

- ★ 8" media
- ★ 2 mounted 120V pumps
- ★ Float and bleed off kit.
- ★ Overflow / drain kit

Heavy-Gauge Galvanized Steel Cabinet:

This finish meets or exceeds requirements for the following tests:

- ★ 1000-Hour Salt Spray Test ASTM B117
- ★ Abrasion Resistance Test ASTM 4060-84
- ★ Impact Resistance Test ASTM D2794
- ★ 2400-Hour Immersion Test ASTM D870
- ★ Adhesion Test ASTM D335



Long-Life Rigid Evaporative Media:

- ★ Genuine Munters® Rigid media with 5 year limited warranty
- ★ Most effective 8" cooling pad



Champion Cooler certifies that the evaporative coolers shown here are licensed to bear the AMCA Seal. The ratings shown are based on tests and procedures performed in accordance with AMCA Publication 211 and comply with the requirements of the Certified Ratings Program.



OF DOMESTIC AND IMPORTED COMPONENTS



AXIAL FAN EVAPORATIVE COOLING ASSEMBLIES



42" AND 48"
HIGH CAPACITY
AXIAL FANS FOR
INDUSTRIAL APPLICATIONS

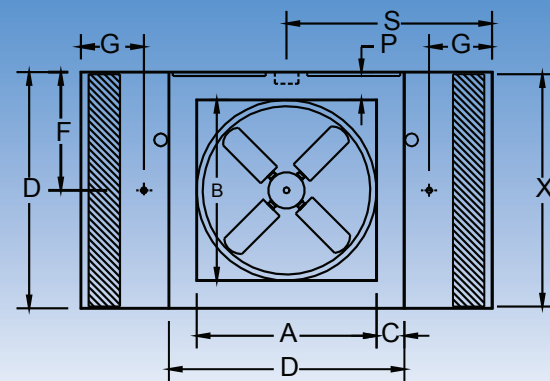

BOTTOM VIEW

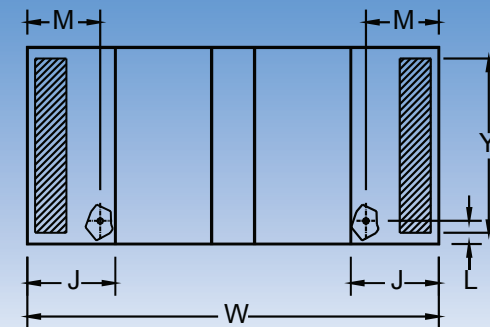

FRONT VIEW

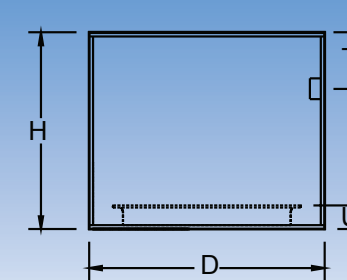

END VIEW



OF DOMESTIC AND IMPORTED COMPONENTS

42" AXIAL FAN

USE DRAWINGS ABOVE WITH THE DIMENSIONAL DATA BELOW †

MODEL	CABINET			DUCT OPENING		DUCT LOCATION		DRAIN LOCATION		WET MODULE		BOT. PAN RISER		MEDIA DIMENSION		WATER SERVICE		ELECTRIC SERVICE		APPROX. TOTAL RESERVOIR CAPACITY	APPROXIMATE WEIGHT (LBS)	
	H	W	D	A	B	C	P	F	G	J	U	X	Y	L	M	S	T	DRY	OPER.			
FAD 242	40 1/8	97 1/4	60 1/4	46	46	7 7/8	7 7/8	30 1/8	12 1/2	18 1/2	6	60	34 1/2	5 7/8	14 5/8	48 5/8	4 3/4			30 GAL.	720	1000

† All Measurements in inches.

SPECIFICATIONS FOR 42" AXIAL FAN

NEW BLOWER SECTION MODEL #	NEW WET SECTION MODEL #	BLOWER SECTION SHIPPING WEIGHT	WET SECTION SHIPPING WEIGHT	PREVIOUS COMPLETE MODEL #	MOTOR					MOTOR PULLEY PART #	*CFM @ EXTERNAL STATIC PRESSURE (INCH WC)			
					HP	Volts	†Amps	Phase	Part #		0	0.1	0.2	
FAD242B	FAD242W8	375	305			3/4	115/208-230	13.8/7.6-6.9	1	110455	583022	12611	10259	6820
						3/4	208-230/460	3.5-3.2/1.6	3	110461-1	583022	12611	10259	6820
					FAD242B111 (115V)	1	115/208-230	16/8	1	110457	110308	13906	11869	7714
					FAD242B112 (230V)									
					FAD242B132 (230V)	1	208-230/460	4.6-4.2/2.1	3	110462-1	110308	13906	11869	7714
					FAD242B134 (460V)									
						1 1/2	115/208-230	20/11-10	1	110459-1	110308	15888	14085	11974
						1 1/2	208-230/460	6.6-6/3	3	110463-1	110308	15888	14085	11974
					FAD242B211 (115V)	2	115/208-230	24/13.2-12	1	110483	110279-003	17550	15973	14122
					FAD242B212 (230V)									
FAD242B232 (230V)	2	208-230/460	7.5-6.8/3.4	3	110464-1	110279-003	17550	15973	14122					
FAD242B234 (460V)														

* Performance shown is for installation type B - Free inlet, ducted outlet. Performance ratings do not include the effects of appurtenances in the airstream. Power rating (BHP) does not include transmission losses.

† Amperage shown is from the National Electrical Code.

INSTALLATION INFORMATION

1. Use amperage shown on motor nameplate to determine motor protector. All external wiring and components such as disconnects, motor starters, and over-current protection are to be field supplied and are not included as part of the evaporative cooler.
2. A separate 120V, 60 Hz. 1-phase pump electric circuit is required to maintain the integrity of the GFCI pump protection and to maintain the U.L. listing of the evaporative cooler.
3. Wet sections are bolted together and include media, 2 mounted 120V pumps, floats, overflow/drain kits and bleed off kits. These components are located inside the wet sections.



MODEL FAD242 AND FAD248 SERIES COOLERS ARE UL LISTED WHEN USED IN NON-DUCTED, SINGLE DISCHARGE APPLICATIONS.

48" AXIAL FAN

USE DRAWINGS ABOVE WITH THE DIMENSIONAL DATA BELOW †

MODEL	CABINET			DUCT OPENING		DUCT LOCATION		DRAIN LOCATION		WET MODULE		BOT. PAN RISER		MEDIA DIMENSION		WATER SERVICE		ELECTRIC SERVICE		APPROX. TOTAL RESERVOIR CAPACITY	APPROXIMATE WEIGHT (LBS)	
	H	W	D	A	B	C	P	F	G	J	U	X	Y	L	M	S	T	DRY	OPER.			
FAD 248	50 1/8	97 1/4	60 1/4	52	52	4 1/8	4 1/8	30 1/8	12 1/2	18 1/2	6	60	44 1/2	5 7/8	14 5/8	48 5/8	14 3/4			30 GAL.	780	1060

† All Measurements in inches.

SPECIFICATIONS FOR 48" AXIAL FAN

NEW BLOWER SECTION MODEL #	NEW WET SECTION MODEL #	BLOWER SECTION SHIPPING WEIGHT	WET SECTION SHIPPING WEIGHT	PREVIOUS COMPLETE MODEL #	MOTOR					MOTOR PULLEY PART #	*CFM @ EXTERNAL STATIC PRESSURE (INCH WC)			
					HP	Volts	†Amps	Phase	Part #		0	0.1	0.2	
FAD248B	FAD248W8	400	340			3/4	115/208-230	13.8/7.6-6.9	1	110455	583022	15198	12523	-
						3/4	208-230/460	3.5-3.2/1.6	3	110461-1	583022	15198	12523	-
						1	115/208-230	16/8	1	110457	110308	16730	14324	-
						1	208-230/460	4.6-4.2/2.1	3	110462-1	110308	16730	14324	-
						1 1/2	115/208-230	20/11-10	1	110459-1	110279-003	19149	17078	14636
						1 1/2	208-230/460	6.6-6/3	3	110463-1	110279-003	19149	17078	14636
					FAD248B211 (115V)	2	115/208-230	24/13.2-12	1	110483	110279-003	21096	19563	18031
					FAD248B212 (230V)									
					FAD248B232 (230V)	2	208-230/460	7.5-6.8/3.4	3	110464-1	110279-003	21096	19563	18031
					FAD248B234 (460V)									

* Performance shown is for installation type B - Free inlet, ducted outlet. Performance ratings do not include the effects of appurtenances in the airstream. Power rating (BHP) does not include transmission losses.

† Amperage shown is from the National Electrical Code.

IMPORTANT CHANGES IN ORDERING MASTERCOOL AXIAL FAN ASSEMBLIES

IN ORDER TO BETTER ACCOMODATE THE DEMAND FOR OUR PRODUCTS, WE HAVE INCORPORATED SOME CHANGES IN THE WAY OUR AXIAL FAN ASSEMBLIES ARE MANUFACTURED STOCKED AND ORDERED. PLEASE TAKE NOTE OF THE FOLLOWING POINTS WHEN ORDERING PRODUCTS LISTED IN THIS BROCHURE.

1. An axial fan assembly is made up of four separate sections that must be ordered individually.
 - BLOWER SECTION
 - WET SECTION
 - MOTOR
 - PULLEY

2. Blower and wet sections are shipped disassembled. **Components are not installed.**

NOTE: Factory assembly is available for an additional fee.

3. MOTOR and PULLEY must be ordered separately.

4. Please note new part numbers for components. (Old part numbers are listed for reference only.)