



## 4375DC DRAINABLE STATIONARY LOUVER

MIAMI-DADE APPROVED

MIAMI-DADE COUNTY, FLORIDA NOTICE OF ACCEPTANCE NUMBER: 17-0222.01 (Expires 01/03/2023)

### STANDARD CONSTRUCTION

#### FRAME

4" (102) deep, 6063T6 extruded aluminum with .081" (2.1) nominal wall thickness. Downspouts and caulking slots provided.

#### BLADES

6063T6 extruded aluminum, .081" (2.1) nominal wall thickness. Drainable blades are positioned at 37<sup>1</sup>/<sub>2</sub>° angle and spaced approximately 5<sup>3</sup>/<sub>32</sub>" (129) center to center.

#### SCREEN

5/8" x .040" (16 x 1) expanded, flattened aluminum bird screen in removable frame. Screen adds approximately 1/2" (13) to louver depth.

#### FINISH

Mill.

#### APPROXIMATE SHIPPING WEIGHT

6 lbs./ft.<sup>2</sup> (29.3 kg/m<sup>2</sup>).

#### MINIMUM SIZE

12"w x 12"h (305 x 305).

#### MAXIMUM SIZE

90" X 120" (2286 X 3048) factory assembly, unlimited width x 120"h (3048) field assembly. Louvers larger than the maximum factory assembly size will require field assembly of smaller sections.

#### INSTALLATION

The 4375DC must be installed per the appropriate installation detail. Reference the appropriate separate installation instruction sheets.

#### BLADE SUPPORTS

Factory installed on louvers over 28" (635) wide. Support depth is 3" (76) on louvers 60" (1524) tall and under. Support depth is 6" (152) on louvers over 60" (1524) tall.

### FEATURES

- Approved for use in open structures with provisions to manage weather infiltration (wet rooms).
- Maximum windload ±130 PSF (6.22 kPa).
- High performance frame system with drainable head collects and removes water to provide excellent water penetration performance.
- Drain gutter in each blade minimizes water cascade between blades.
- 49% Free Area in 48" x 48" (1.2 x 1.2) size.
- Published performance ratings based on testing in accordance with AMCA Publication 511.
- Aluminum construction for low maintenance and high resistance to corrosion.
- All welded construction.
- Miami Dade NOA #17-0222.01

### VARIATIONS

Variations to the basic design of these louvers are available at additional cost. They include:

- Extended sill.
- Front or rear security bars.
- Filter racks.
- Universal Sleeve
- Blank Off Panels
- Integral Flange
- A variety of bird and insect screens.
- Optional finishes available at additional cost: prime coat, baked enamel (modified fluoropolymer), epoxy, Pearledize, Kynar, clear and color anodize. (Some variation in anodize color consistency is possible.)

Consult Reliable for other special requirements.

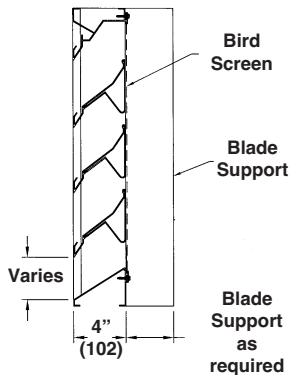
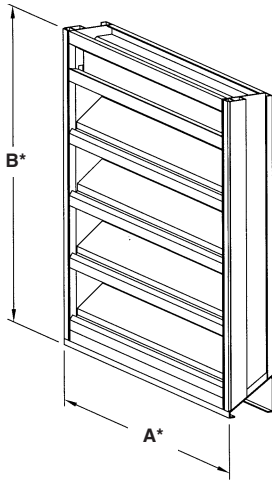

Dimensions in inches, parenthesis ( ) indicate millimeters.

\*Units furnished 1/2" (13) smaller than given opening dimensions.

TAG	QTY.	SIZE		FRAME	WALL DEPTH	VARIATIONS
		A*-WIDE	B*-HIGH			
<b>PROJECT</b>				<b>LOCATION</b>		
<b>ARCH./ENGR.</b>				<b>CONTRACTOR</b>		
<b>REPRESENTATIVE</b>				<b>DATE</b>		

**FRAME CONSTRUCTION**

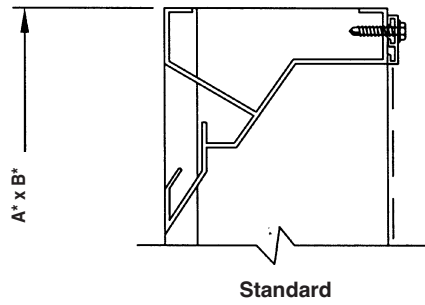

**MULTI SECTION FIELD SPLICE DETAIL**

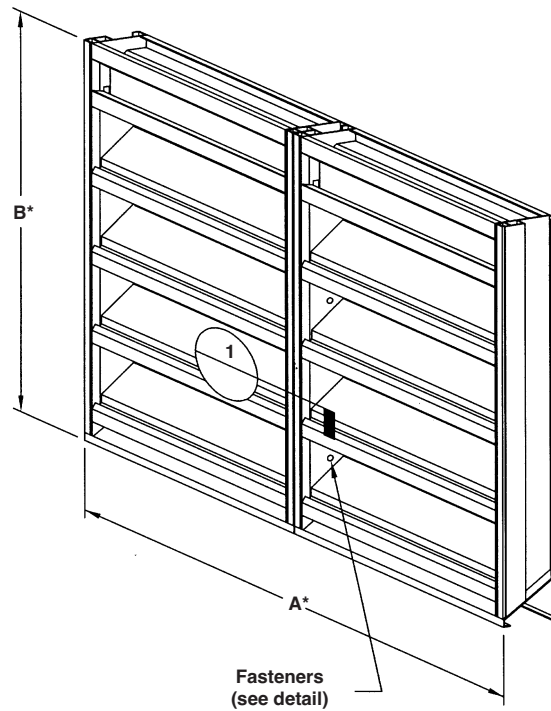

**GENERAL NOTES:**

1. Reference separate Installation Instruction sheets for installation details. Each frame style has a distinct installation method that must be compiled for Miami-Dade and Florida Approval. It is the responsibility of the installing contractor to properly install the louvers per the appropriate detail.
2. On special orders, Reliable may provide submittal and/or shop drawings. Reference these drawings for additional installation information.
3. Louvers may be provided with hidden vertical blade supports (HVBS) that increase overall installation depth by several inches. Consult Reliable Louver Engineering for exact HVBS depth.
4. Louvers wider than the maximum single section width will be shipped in multiple sections and will require field assembly.

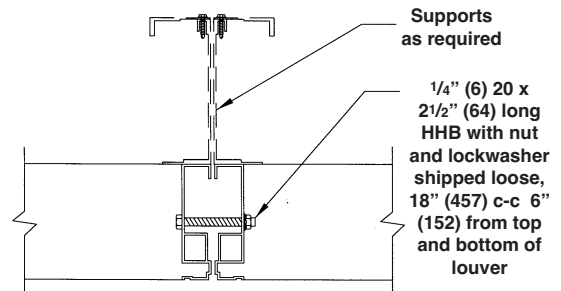

**1. SPLICE DETAIL PLAN**

**PRESSURE DROP**

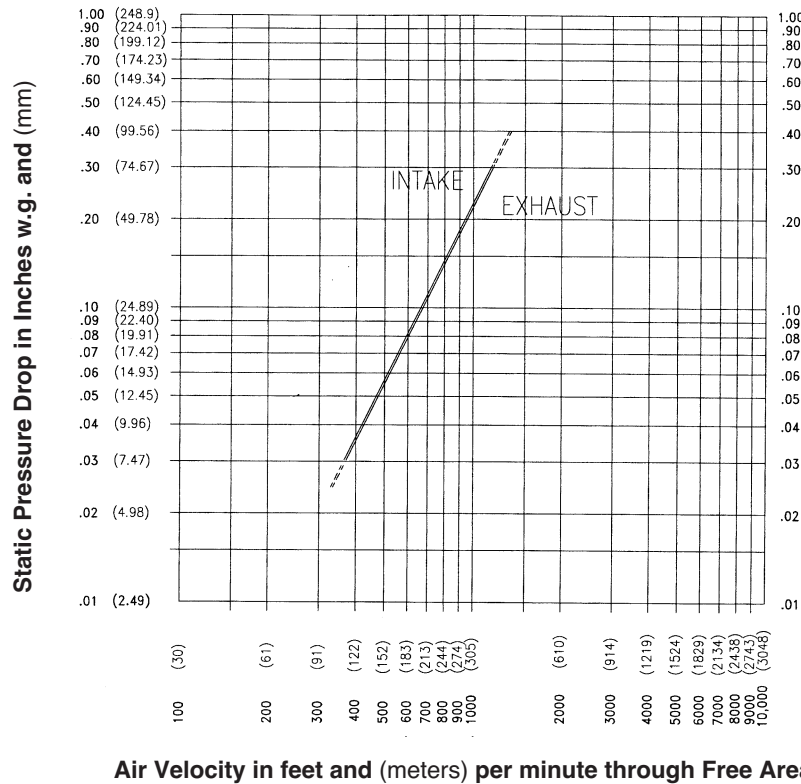

**WATER PENETRATION GRAPH**

Test size 48" wide x 48" high (1219 x 1219)

Beginning point of water penetration at .01 oz./sq. ft. is 1055 fpm (322 m/min).

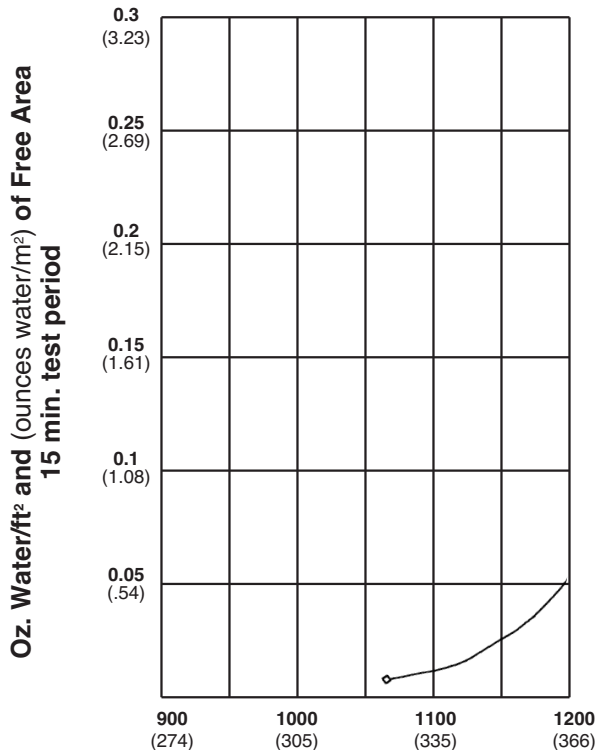

Free Area Velocity in feet (meters) per minute  
Standard air .075 lb/ft³

Ratings do not include the effect of a bird screen.



Reliable Products certifies that the 4375DC Louvers shown herein are licensed to bear the AMCA Seal. The ratings shown are based on tests and procedures performed in accordance with AMCA Publication 511 and comply with the requirements of the AMCA Certified Ratings Program. The AMCA Certified Ratings Seal applies to air performance ratings and water penetration ratings only.



## MIAMI-DADE COUNTY HURRICANE STRUCTURAL TEST PERFORMANCE

SIZES TESTED: 240<sup>1</sup>/<sub>16</sub>"w x 120"h (6098 x 3048) and 240<sup>1</sup>/<sub>16</sub>"w x 60"h (6098 x 1524)

### TAS 201-94 LARGE MISSILE IMPACT TEST

MISSILE TYPE	VELOCITY IN FT/SEC (M/SEC)	IMPACTS
9 lb (4kg) Southern Pine 2" x 4" (51 x 102)	50 (15.24)	7

### TAS 202-94 UNIFORM STATIC AIR PRESSURE TEST

LOAD IN PSF (kPA)	LOAD DURATION	LOUVER RECOVERY
+111 (+5.3)	30 seconds	100%
-111 (-5.3)	30 seconds	100%
+148 (+7.1)	30 seconds	100%
-148 (-7.1)	30 seconds	100%
+222 (+10.6)	30 seconds	100%
-222 (-10.6)	30 seconds	100%

### TAS 203-94 CYCLIC WIND PRESSURE TEST

CYCLES	LOAD IN PSF (kPA)	LOAD DURATION CYCLE	LOUVER RECOVERY
600	+74 (+3.54)	1 to 3 seconds	100%
600	-74 (-3.54)	1 to 3 seconds	100%
70	+88.8 (+4.25)	1 to 3 seconds	100%
70	-88.8 (-4.25)	1 to 3 seconds	100%
1	+192.4 (+9.21)	1 to 3 seconds	100%
1	-192.4 (-9.21)	1 to 3 seconds	100%

## FREE AREA GUIDE

Free Area Guide shows free area in ft<sup>2</sup> and m<sup>2</sup> for various sizes of 4375DC.  
Width – Inches and Meters

	12 0.30	18 0.46	24 0.61	30 0.76	36 0.91	42 1.07	48 1.22	54 1.37	60 1.52	66 1.68	72 1.83	78 1.98	80 2.03
12	0.16	0.36	0.57	0.78	0.99	1.20	1.41	1.62	1.82	2.03	2.24	2.45	2.52
0.30	0.01	0.03	0.05	0.04	0.09	0.11	0.13	0.15	0.17	0.19	0.21	0.23	0.23
18	0.28	0.65	1.02	1.39	1.76	2.13	2.50	2.87	3.24	3.62	3.99	4.36	4.48
0.46	0.03	0.06	0.09	0.13	0.16	0.20	0.23	0.27	0.30	0.34	0.37	0.41	0.42
24	0.40	0.93	1.47	2.00	2.53	3.07	3.60	4.13	4.67	5.20	5.73	6.26	6.54
0.61	0.04	0.09	0.14	0.19	0.24	0.29	0.33	0.38	0.43	0.48	0.53	0.58	0.54
30	0.52	1.22	1.91	2.61	3.30	4.00	4.70	5.39	6.09	6.78	7.48	8.17	8.54
0.76	0.05	0.11	0.18	0.24	0.31	0.37	0.44	0.50	0.57	0.63	0.70	0.78	0.70
36	0.62	1.44	2.27	3.09	3.92	4.74	5.57	6.40	7.22	8.05	8.87	9.70	10.17
0.91	0.06	0.13	0.21	0.29	0.36	0.44	0.52	0.59	0.67	0.75	0.83	0.90	0.93
42	0.74	1.73	2.72	3.70	4.69	5.68	6.67	7.65	8.64	9.63	10.62	11.60	12.17
1.07	0.07	0.16	0.25	0.34	0.44	0.53	0.62	0.71	0.80	0.90	0.99	1.08	1.11
48	0.86	2.01	3.16	4.31	5.46	6.61	7.76	8.91	10.06	11.21	12.36	13.51	14.17
1.22	0.08	0.19	0.29	0.40	0.51	0.61	0.72	0.83	0.94	1.04	1.15	1.26	1.29
54	0.98	2.30	3.61	4.92	6.23	7.55	8.86	10.17	11.48	12.80	14.11	15.42	16.17
1.37	0.09	0.21	0.34	0.46	0.58	0.70	0.82	0.95	1.07	1.19	1.31	1.43	1.47
60	1.11	2.58	4.06	5.53	7.01	8.48	9.96	11.43	12.90	14.38	15.85	17.33	18.17
1.52	0.10	0.24	0.38	0.51	0.65	0.79	0.93	1.06	1.20	1.34	1.47	1.61	1.66
66	1.20	2.81	4.41	6.02	7.62	9.23	10.83	12.43	14.04	15.64	17.25	18.85	19.77
1.68	0.11	0.26	0.41	0.56	0.71	0.86	1.01	1.16	1.31	1.45	1.60	1.75	1.80
72	1.33	3.09	4.86	6.63	8.39	10.16	11.93	13.69	15.46	17.23	18.99	20.76	21.67
1.83	0.12	0.29	0.45	0.62	0.78	0.94	1.11	1.27	1.44	1.60	1.77	1.93	1.99
78	1.45	3.38	5.31	7.23	9.16	11.09	13.02	14.95	16.88	18.81	20.74	22.67	23.67
1.98	0.13	0.31	0.49	0.67	0.85	1.03	1.21	1.39	1.57	1.75	1.93	2.11	2.17
84	1.57	3.66	5.75	7.84	9.94	12.03	14.12	16.21	18.30	20.39	22.49	24.58	25.67
2.13	0.15	0.34	0.53	0.73	0.92	1.12	1.31	1.51	1.70	1.90	2.09	2.29	2.35
90	1.69	3.94	6.20	8.45	10.71	12.96	15.21	17.47	19.72	21.98	24.23	26.49	27.64
2.29	0.16	0.37	0.58	0.79	1.00	1.21	1.41	1.62	1.83	2.04	2.25	2.46	2.53
96	1.81	4.23	6.65	9.06	11.48	13.89	16.31	18.73	21.14	23.56	25.98	28.39	29.60
2.44	0.17	0.39	0.62	0.84	1.07	1.29	1.52	1.74	1.97	2.19	2.42	2.64	2.72
102	1.91	4.46	7.00	9.55	12.0	14.64	17.19	19.73	22.28	24.82	27.37	29.92	30.76
2.59	0.18	0.41	0.65	0.89	1.12	1.36	1.60	1.84	2.07	2.31	2.55	2.78	2.86
108	2.03	4.74	7.45	10.16	12.87	15.57	18.28	20.99	23.70	26.41	29.12	31.82	32.73
2.74	0.19	0.44	0.69	0.94	1.20	1.45	1.70	1.95	2.20	2.46	2.71	2.96	3.04
114	2.15	5.02	7.89	10.77	13.64	16.51	19.38	22.25	25.12	27.99	30.86	33.73	34.69
2.90	0.20	0.47	0.73	1.00	1.27	1.54	1.80	2.07	2.34	2.60	2.87	3.14	3.23
120	2.27	5.31	8.34	11.37	14.41	17.44	20.47	23.51	26.54	29.57	32.61	35.64	36.65
3.05	0.21	0.49	0.78	1.06	1.34	1.62	1.90	2.19	2.47	2.75	3.03	3.31	3.41