



511 SOUTH 7TH STREET
DELANO MN 55328
Phone: 763.972.2981
Fax: 763.972.2911

www.industriallouvers.com
ilinfo@industriallouvers.com

MODEL 655XP

STANDARD CONSTRUCTION

Frame and blades to be 6" deep .081 extruded aluminum 6063 alloy.

1/2" mesh .063 flattened expanded aluminum bird screens in a removable extruded aluminum frame.

Finish to be mill.

TECHNICAL DATA



Industrial Louvers, Inc. certifies that Model 655XP shown hereon is licensed to bear the AMCA Seal. The ratings shown are based on tests and procedures performed in accordance with AMCA Publication 511 and comply with the requirements of the AMCA Certified Ratings Program. The AMCA Certified Ratings Seal applies to air performance ratings and water penetration ratings.

INSTALLATION

Model 655XP should be installed in accordance with manufacturers recommended attachment method and in accordance with state and federal building codes.

WARRANTY

All materials and workmanship are warranted for a period of 1 year from date of completion.

MAINTENANCE

None required.

FEATURES

- All sizes are custom fabricated to meet project requirements.
- Integral water spouts at the jambs to drain water from the blades to the exterior of the building.
- Clip angles for installation.
- Mechanically fastened construction.

OPTIONAL ACCESSORIES

Many optional accessories to the basic design are available at an additional cost. They include:

- Extended sill flashing
- Flanged frames of various sizes
- Hinged access panels
- Subframes
- Continuous perimeter angles
- Visible or invisible mullions for multiple section requirements.
- Anodized, Baked Enamel or Kynar finish

Please contact the factory for other special requirements.

SUGGESTED SPECIFICATIONS

Furnish and install where indicated on the drawings ILI extra performance storm-resistant drainable frame Model 655XP louvers as manufactured by Industrial Louvers, Inc., Delano, MN. Frames and blade thickness to be .081" extruded aluminum 6063 alloy. The frame shall be designed to collect and drain water to exterior at sill by means of channels in the jambs. Sill and jamb frames shall be mechanically fastened and caulked to help prevent water penetration to the interior wall construction. Blades are mechanically fastened using stainless steel fasteners.

Louvers shall bear the AMCA Certified Ratings Seal for both air performance and water penetration. The louvers shall have a minimum of 8.07 sq. ft. (50%) free area on a 48 inch x 48 inch louver. The rating shall show a maximum water penetration of .01 oz. at an air flow of 1028.1 FPM. The Static Pressure Loss to be not more than .15 inch of water gage at an air flow of 836 FPM free area velocity.

CATALOG NO. 655XP

Rev: JANUARY 2004

MODEL 655XP

Free Area in Square Feet And Square Meters

Free Area AMCA Licensed for openings up to 72" X 120".
For free area data for larger openings, contact factory.

FREE AREA IN SQUARE FEET AND SQUARE METERS						
3048. mm	0.454	0.998	1.543	2.087	2.632	3.176
120"	4.884	10.745	16.606	22.466	28.327	34.188
2743.2 mm	0.395	0.870	1.344	1.819	2.293	2.767
108"	4.256	9.362	14.469	19.575	24.682	29.788
2438.4 mm	0.352	0.775	1.197	1.620	2.043	2.465
96"	3.791	8.340	12.889	17.438	21.987	26.536
2133.6 mm	0.309	0.679	1.050	1.421	1.791	2.162
84"	3.325	7.314	11.303	15.293	19.282	23.271
1828.8 mm	0.264	0.582	0.899	1.217	1.534	1.852
72"	2.847	6.264	9.681	13.097	16.514	19.931
1524. mm	0.206	0.454	0.701	0.949	1.196	1.443
60"	2.220	4.884	7.547	10.211	12.874	15.538
1219.2 mm	0.163	0.359	0.554	0.750	0.946	1.141
48"	1.755	3.861	5.967	8.073	10.179	12.285
914.4 mm	0.120	0.263	0.407	0.550	0.694	0.837
36"	1.288	2.833	4.379	5.924	7.470	9.015
609.6 mm	0.075	0.166	0.256	0.346	0.437	0.527
24"	0.811	1.784	2.757	3.729	4.702	5.675
304.8 mm	0.017	0.038	0.058	0.079	0.099	0.120
12"	0.184	0.405	0.626	.846	1.067	1.288
H/W	304.8 mm	609.6 mm	914.4 mm	1219.2 mm	1524. mm	1828.8 mm
	12"	24"	36"	48"	60"	72"

Performance Chart

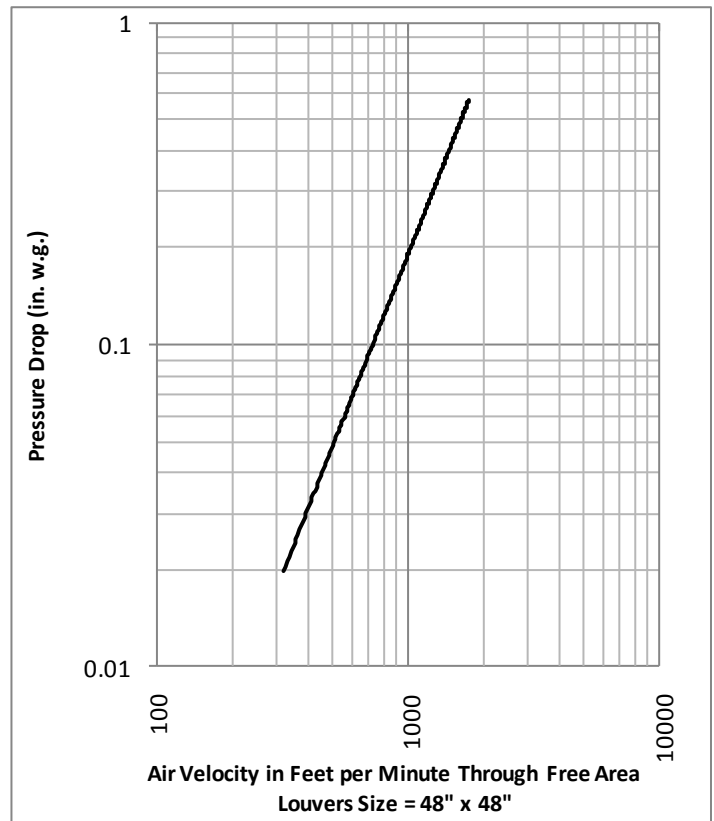

The AMCA Certified Ratings Seal applies to Air Capacities in the intake mode only.

Water Penetration Chart

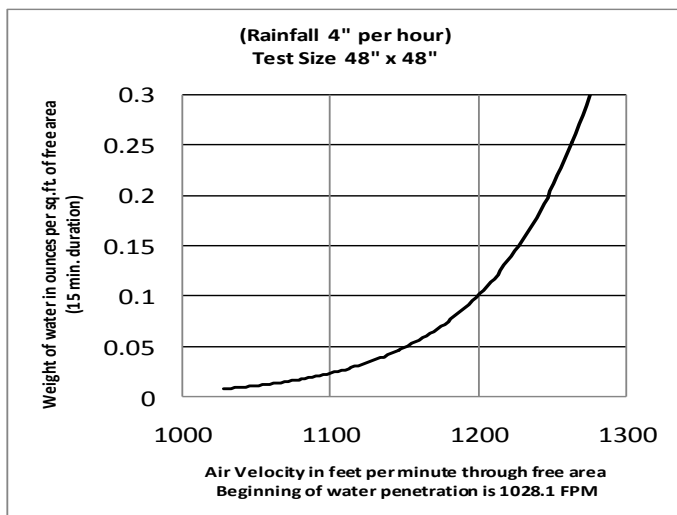

Ratings do not include the effect of a bird screen.

NOTE: All tests are for standard .075 lb./cu. ft.

CATALOG NO. 655XP

JANUARY 2004



Industrial Louvers, Inc. certifies that Model 655XP shown hereon is licensed to bear the AMCA Seal. The ratings shown are based on tests and procedures performed in accordance with AMCA Publication 511 and comply with the requirements of the AMCA Certified Ratings Program. The AMCA Certified Ratings Seal applies to air performance ratings and water penetration ratings.



MODEL 655XP

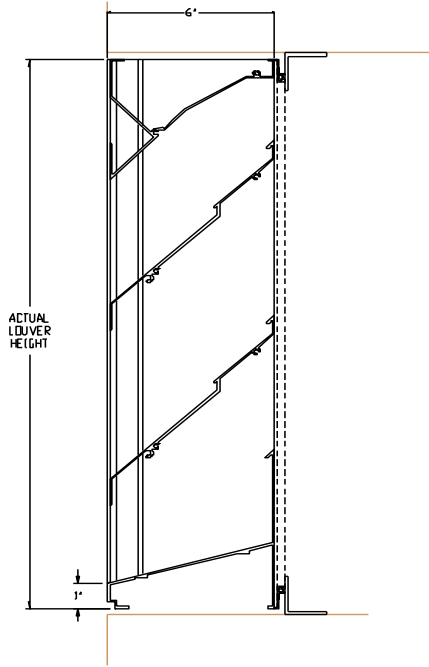

VERTICAL SECTION

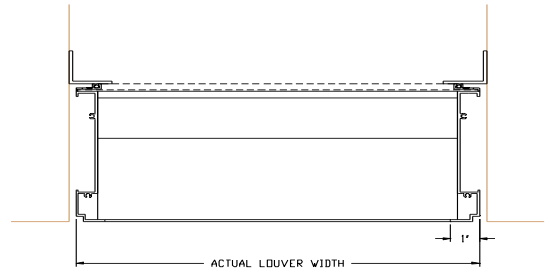

HORIZONTAL SECTION

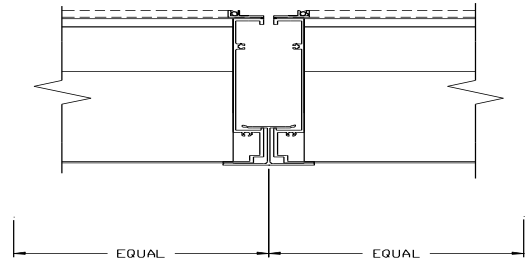

VISIBLE MULLION DETAIL

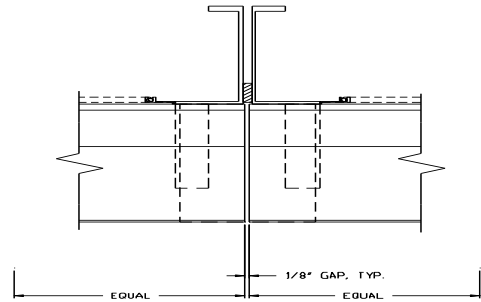

INVISIBLE MULLION DETAIL

ACCESSORIES:

- SILL FLASHING - DEPTH _____
- SCREEN _____
- FINISH _____
COLOR _____
- OTHER _____

ITEM NO.	QTY	SIZE	Actual	M.O.	MULLION TYPE	NO. OF SECTIONS	REMARKS
		WIDTH	HEIGHT				

PROJECT _____	REPRESENTATIVE _____
LOCATION _____	ILI JOB NO. _____ REP NO. _____
ARCH/ENGR. _____	Industrial Louvers, Inc. Phone: 763-972-2981
CONTRACTOR _____	511 South 7th Street Fax: 763-972-2911
DATE _____	Delano, MN 55328
	CATALOG NO. 655XP Rev: JANUARY 2004